

» Features

- Ultra small type, light weight
- Terminals are insert molded against flux penetration during soldering.
- Good feeling and more levers are applied.

» Applications

- Operating in all types of electronic equipment such as appliances, audio, mouse, office, equipment, communications apparatus, etc.



» Specifications

Electrical Characteristics	
Rating	3A 125V AC / 250V AC or 1A 250 V AC
Insulating Resistance	100MΩ Min (at 500 VDC)
Dielectric Strength	AC 500V (50/60 Hz for 1 minute)
Contact Resistance	50mΩ Max.(Initial)
Mechanical Characteristics	
Operating Frequency	Mechanical: max. 120 operations/minute. Electrical: max. 10 operations/minute.
Operating Speed	1.0mm to 500mm/s (pin plunger models)
Vibration	10 to 55Hz, 1.5 mm double amplitude
Operating Life	Electrical: 10,000 cycles. Mechanical: 30,000 cycles.
Climatic Characteristics	
Degree of Protection	IP40 (Excluding the terminals)
Operating Temperature	-0°C ~ +55°C
Operating Humidity	95% max. (for 5°C to 35°C)

» Product Selection

DH05

1 2

1. ACTUATOR TYPE

- 0: Pin Plunger
- 1: Short hinge lever

2. TERMINAL TYPE

- P : P.C.B Terminal

» Operating Characteristics

Actuator Type	0 Pin Plunger	1 Hinge Lever
Operating Force max.	150gf	80gf
Pretravel max.	0.5mm	-----
Overtravel min.	0.25mm	0.55mm
Movement Differential max.	0.12mm	0.5mm
Releasing Force min.	20gf	5gf
Operating Position	5.5±0.3mm	6.8±1.5mm

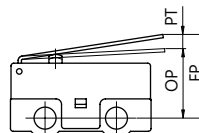
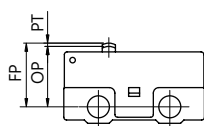

» Dimensions

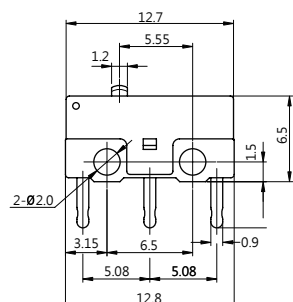

» Mounting Hole

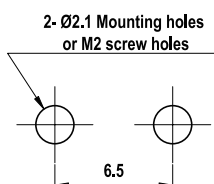

» For P.C.B. Terminal

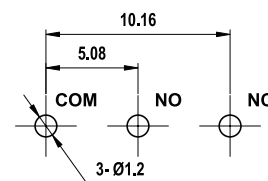

HIGHLY

B23

Design, specifications are subject to change without notice.